

AlliSport Double-Core updated intercooler fitting notes

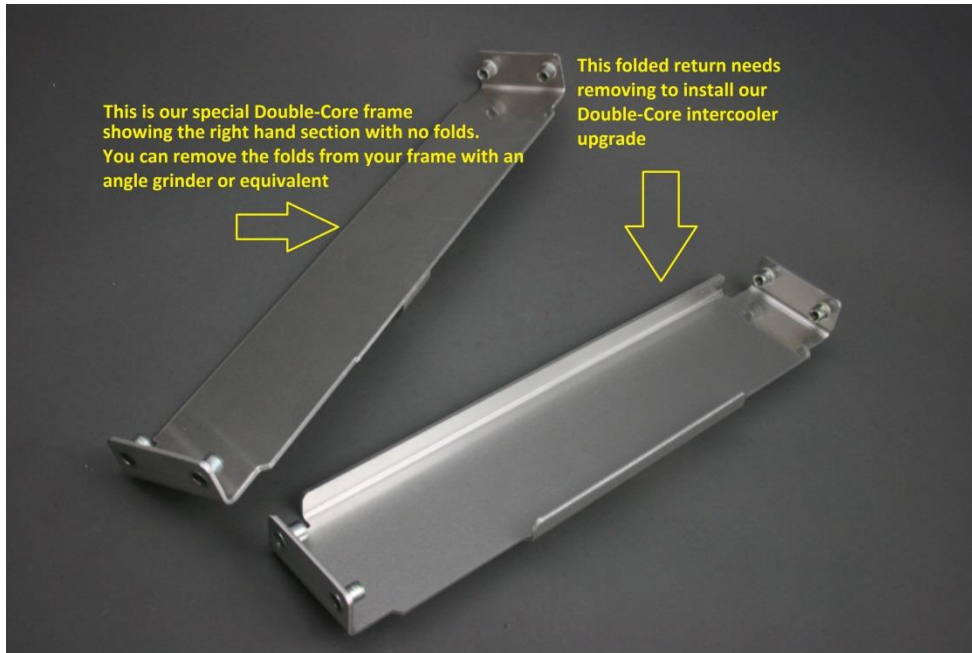

Please see separate sheet for fuel pump instructions





Fuel Pump Adjustment

Plan of Fuel Pump

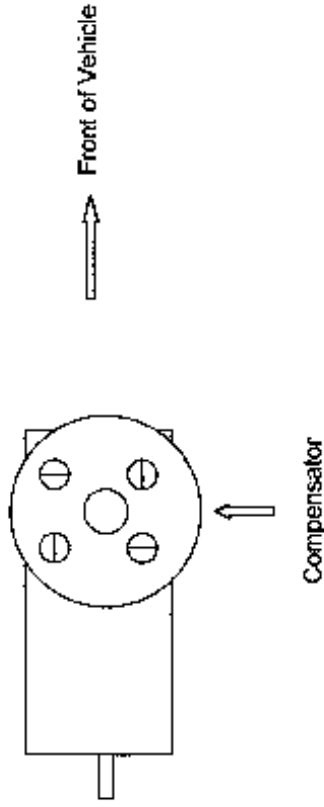

Remove the four screws on top of the Compensator and remove the cap. Carefully lift out the rubber diaphragm complete with shaped pin below. One side of the pin has a larger step at the base and it must be replaced with this step towards the *front* of the vehicle. This will give the correct setting to compensate for the leaner mixture provided by the larger intercooler. This setting is designed to suit the *large front mount* intercooler kit and is the maximum fuel setting recommended. For *Option 1 and Double-Core* fitment intercoolers, use a setting between the largest step and the start point. You can tailor the settings to suit your own requirements. If you are unsure or for further information please contact us! *These adjustments must not be attempted before installing the updated Intercooler.*

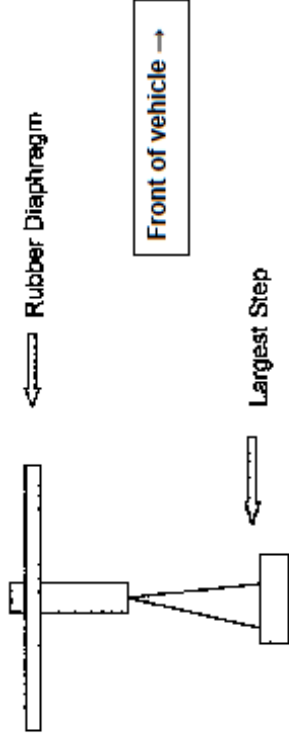

Please Note:
 The settings described above are assuming a well-serviced healthy engine and are likely to vary per car. We recommend checking turbo boost pressure, lift pump operation and removal of EGR and CAT (300 Tdi).
 It can be advantageous to advance the timing slightly.
These adjustments must not be attempted before installing the Intercooler. We cannot be held responsible for incorrect adjustment or any damage that may occur as a result of modifications. Remember we offer a fitting service if you are unsure.